

TOLERANCES acc. to ISO / TOLERANSEN entl. ISO
 Applicable where no tolerance is indicated.
 Gültig für Toleranzen ej direkt angesetzt
 For machining / Für bearbeitung ISO 2768-mk
 For welding / Für Schweissen ISO 13920-BF
 Surface finish acc. to ISO 15622 Machined surfaces
 Yläpääntelä enligt ISO 1302. For bea...

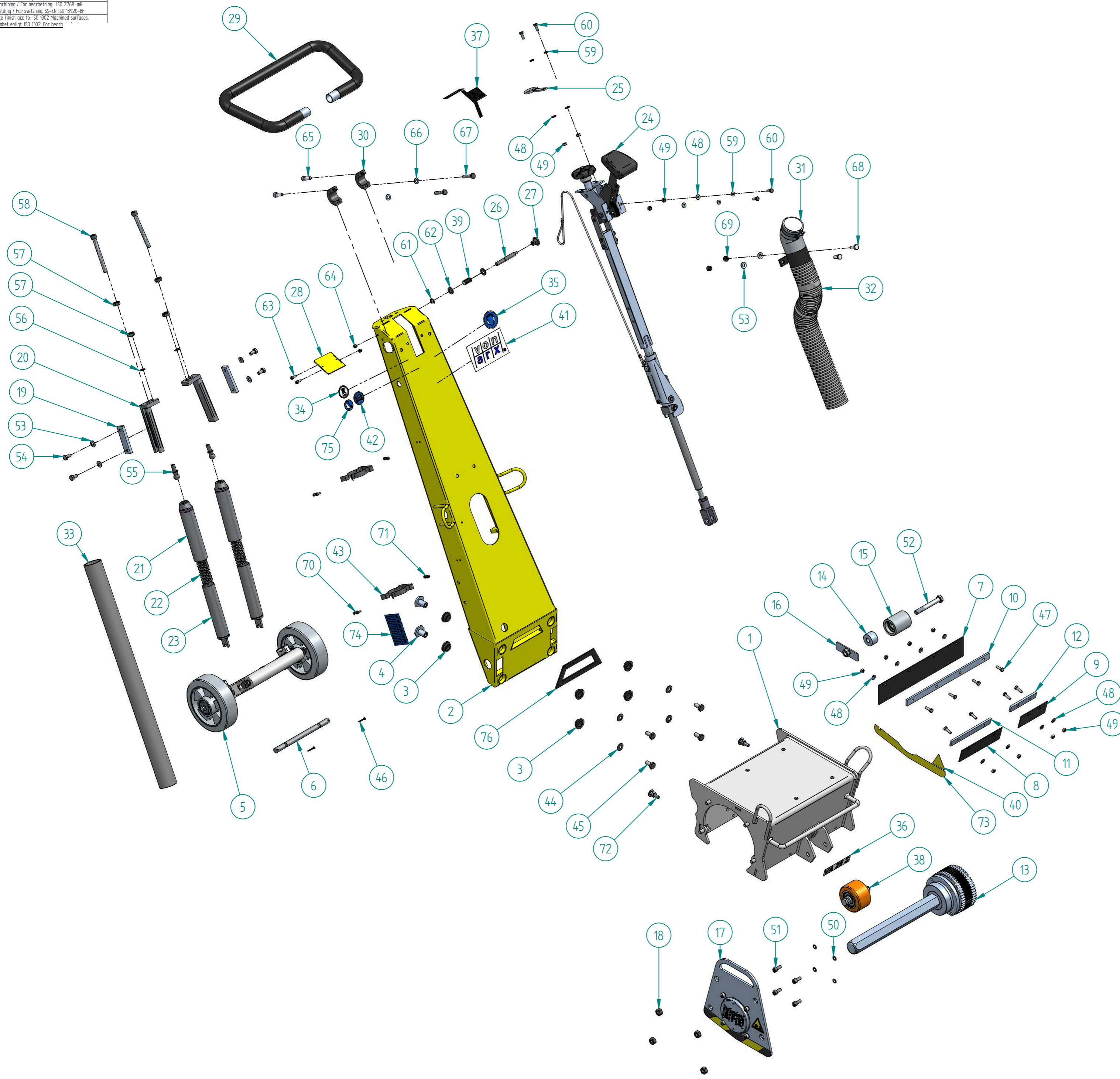

Item	Artikelnummer	Document Number	Title	Quantity
1	702346	644.0101e	HOUSING VA 25 S	1
2	706106	644.0201o	HANDLE BAR FOR VA 25S	1
3	702624	655.0114a	RUBBER MOUNTING	8
4	702625	655.0115a	CLAMPING SLEEVE	4
5	702521	654.06.00	CHASSIS ASSEMBLED FOR BREAK	1
6	702365	644.0218	SHAFT	1
7	702348	644.0104a	DUST SHIELD	1
8	702349	644.0105	DUST SHIELD	1
9	702350	644.0106	DUST SHIELD	1
10	702460	654.0113c	CLAMPING STRIP	1
11	702462	654.0115	CLAMPING STRIP	1
12	702463	654.0116	CLAMPING STRIP	1
13	706130	644.07.00	DRIVE SHAFT ASSEMBLED FOR VA 2	1
14	702468	654.0121	DISTANCE SLEEVE FOR ROLLER FOR	1
15	702473	654.0127	BELT TENSIONING ROLLER	1
16	702469	654.0122d	FASTING BRACKET	1
17	706131	644.31.00	HOUSING COVER ASSEMBLED	1
18	702466	654.0119	NUT FOR HOUSING COVER	4
19	703025	665.08.25a	BRACKET	2
20	702364	644.0217b	ADJUSTMENT PROFILE VA 25 S	2
21	702362	644.0215	UPPER SPRING GUIDE	2
22	706110	644.0219	COMPRESSION SPRING VA 25 S	2
23	702363	644.0216c	LOWER SPRING GUIDE	2
24	702366	644.0300f	DEAD-MAN DEVICE	1
25	703028	665.08.28a	ROPE GUIDE	1
26	702357	644.02.08	BOLT TO VA 25 S	1
27	703056	665.74.14	HANDLE WITH BLIND HOLE ELESA	1
28	707470	644.02.22a	FIXING BRACKET EMERGENCY OFF	1
29	703006	665.08.04a	CLAMP GRIP	1
30	702636	655.0204c	CLAMPING RING	2
31	702653	655.04.10	LINK JOINT	1
32	702675	655.04.04	SUCTION TUBE	1
33	702673	655.04.02c	SUCTION TUBE	1
34	708794	625.0136	ADHESIVE "NO HOUSEHOLD WASTE"	1
35	701669	630.02.47	STICKER: AUDITORI PROTECTION	1
36	702378	644.42.01	STICKER: VA-25S	1
37	703005	665.08.03b	PLATES FOR VA 25 S / VA 30 S /	1
38	109377	630.01.24	FRONT WHEEL COMPL.	1
39	110451	644.02.21	COMPRESSION SPRING	1
40	115649	625.00.05	STICKER "WARNING CUTTER SHAFT"	1
41	703577	788.42.64	STICKER VON ARX 130 X 75	1
42	706129	788.42.66	STICKER "INFO"	1
43	108458	792.64.95	SPRING CLAMP	2
44	113919	BN_13292_M10	SAFETY WASHER	4
45	100614	BN_56_M10x20	HEXAGONAL SCREW	4
46	108364	BN_912_03_2x25	SPLINT	2
47	104267	BN_56_M6x20	HEXAGONAL SCREW	8
48	113917	BN_13292_M6	RIP-LOCK LOCKING WASHER	12
49	102334	BN_117_M6	HEXAGONAL NUT	12
50	102286	BN_792_M8	SAFETY WASHER	4
51	100293	BN_3_M8x18	CYL. SCREW	4
52	107870	BN_57_M12x90	HEXAGONAL SCREW	1
53	113918	BN_13292_M8	RIP-LOCK LOCKING WASHER	6
54	101599	BN_56_M8x16	HEXAGONAL SCREW	4
55	110390	BN_486_K16_SW13_M10	BALL STUD IN C SHAPE	2
56	103335	BN_792_M10	SAFETY WASHER	2
57	102287	BN_117_M10	HEXAGONAL NUT	4
58	110284	BN_7_M10x100	ALLEN SCREW	2
59	107358	BN_721_M6	WASHER	4
60	102332	BN_56_M6x16	HEXAGONAL SCREW	4
61	110452	BN_810_8	SAFETY WASHER	1
62	106300	BN_715_M10	WASHER	2
63	100594	BN_3_M5x12	ALLEN SCREW	2
64	106665	BN_161_M5	SAFETY NUT	2
65	105923	BN_3_M8x25	ALLEN SCREW	2
66	101670	BN_715_M8	WASHER	2
67	107938	BN_56_M8x40	HEXAGONAL SCREW	2
68	101600	BN_56_M8x20	HEXAGONAL SCREW	2
69	101822	BN_117_M8	HEXAGONAL NUT ~0.80	2
70	101590	BN_3_M4x10	ALLEN SCREW	4
71	108692	BN_161_M4	SAFETY NUT	4
72	108013	BN_248_M8x30	ROUNDHEAD SCREW WITH NUT FOR V	2
73	111727		STRIPE BAND -DANGER-	0.3
74	112450		SICKER - DIF.CUTTERS-	1
75	115647		STRIPE BAND LABEL Nr:6021	1
76	203334		SEAL RIBBON VITOFLEX NW 152 BL	0.6
77	706409	644.03.04	SET OF SPARE PARTS FOR "S"TYPE	1
78	108042	792.65.01	FORK WRENCH	1
79	900018		LABEL SWISS DESIGN	1

Drawn By	Date	Approved Date	Approved By	Material	Dimension
DD	16.7.2018	30.10.2019	MS		
Units : mm			SIZE A2		
		Description		Article Number	
		VA-25S BASIC DEVICE		702345	
				DWG NO	
				644.00.00	
Part/Assembly File			sheet of	Rev.	
6440000.asm			1 1		

THE INFORMATION CONTAINED IN THIS DRAWING IS THE SOLE PROPERTY OF VON ARX. EOOD REPRODUCTION IN PART OR WHOLE WITHOUT THE WRITTEN PERMISSION OF VON ARX EOOD IS PROHIBITED.