

TOLERANCES acc. to ISO / TOLERANSEN entl. ISO
 Applicable where no tolerance is indicated.
 Gültig für Toleranzen bei direkt umgesetzten
 For machining / Für Bearbeitung ISO 2768-mk
 For welding / Für Schweissen SS-DIN ISO 13923-BF
 Surface finish acc. to ISO 15622 Machine surfaces
 Oberflächenfinish nach ISO 1302. Für bearbeitete Flächen

Rev. No	Revision description	Date	Sign
c	Dust outlet and electrical switch revised.	09/04/2021	GA
d	Motor corrected to 400/690V, star-delta switch returned.	25/06/2021	MS
e	Cable glands adjusted for new Busck motor.	10/11/2021	MS
f	Weight plate fastener changed.	19/01/2022	GA

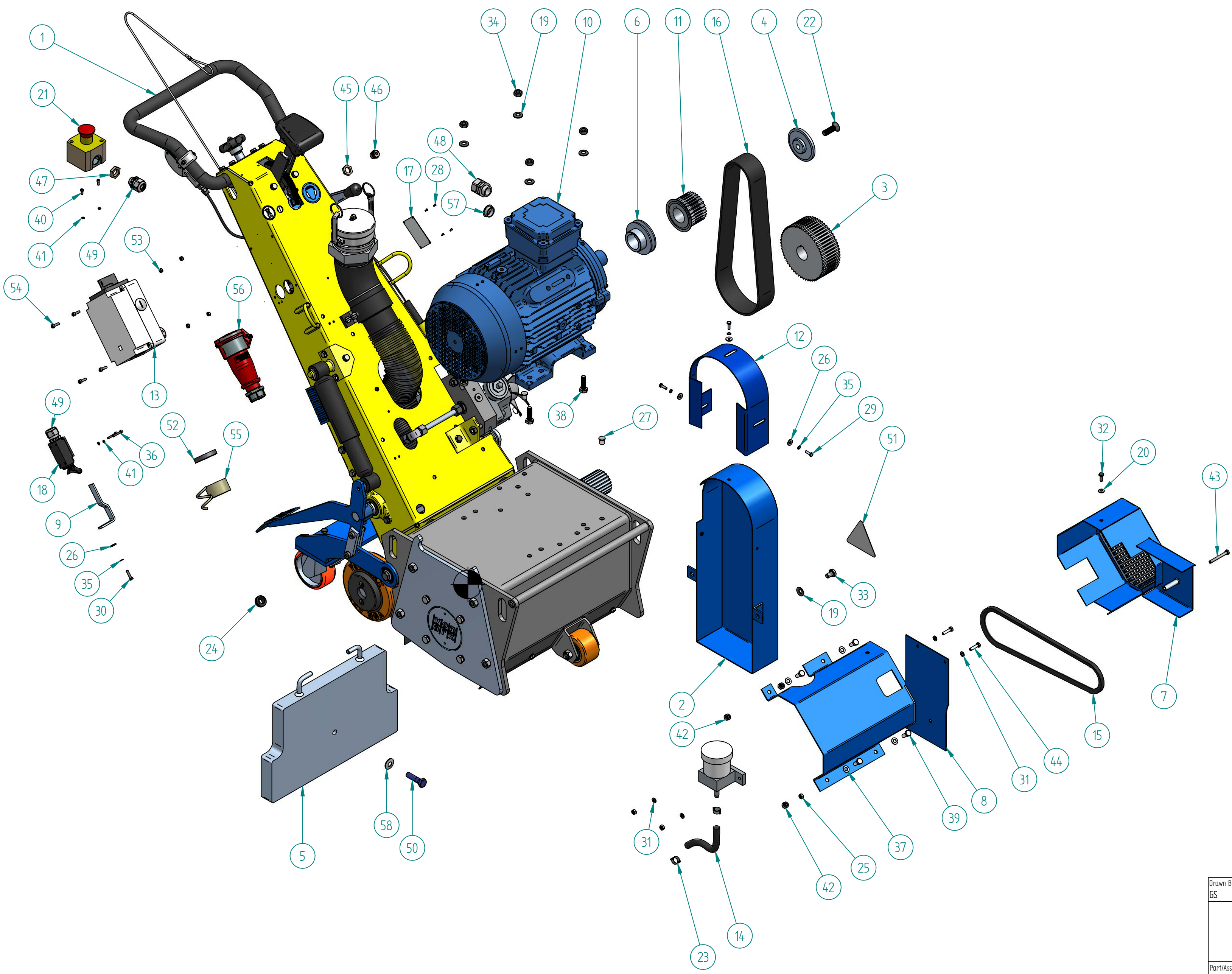

Item	Artikelnummer	Document Number	Title	Quantity
1	707230	668.00.00f	VA-30SH BASIC DEVICE	1
2	707516	668.21.13	BELT GUARD (ELECTRICAL)	1
3	707513	668.21.16	BELT PULLEY 55-8M-50	1
4	707512	668.21.17	SPECIAL WASHER DISC	1
5	707222	668.21.06e	ADDITIONAL WEIGHT PLATE FOR VA	1
6	707221	668.21.05b	TOOTHED PULLEY FOR MOTOR VA 30	1
7	707218	668.21.02a	FAN WHEEL PROTECTION ELECTR.	1
8	707217	668.21.01b	PUMP PROTECTION ELECTR.	1
9	703037	665.09.08a	BEVELLED PROFIL FOR SWITCH	1
10	114257	665.21.10	ELECTRIC MOTOR TYP TE 132M	1
11	707514	668.21.15a	PULLEY	1
12	707518	668.21.14	ADDITIONAL BELT GUARD	1
13	707231	668.13.00	SWITCH ASSEMBLED VA 30 S 7,5 K	1
14	708723	668.02.20	PRESSURE HOSE MAAG LW 8X15	0.4
15	114629	668.21.08	V-BELT ASPDRIVE	1
16	109450	635.01.39	TOOTHED BELT 960-8MGT3-50	1
17	703559	788.42.31d	TYPE PLATE	1
18	114997	791.38.39	POSITION SWITCH	1
19	113919	BN_13292_M10	SAFETY WASHER	6
20	113917	BN_13292_M6	RIP-LOCK LOCKING WASHER	1
21	110942	791.80.04	CASING EMERGENCY STOP	1
22	110428	792.61.93	COUNTERSUNK SCREW	1
23	109397	792.64.58	CLAMP	2
24	109046	791.46.54	CABLE RETAINER	1
25	108693	BN_161_M6	SAFETY NUT	3
26	108573	BN_733_M5	WASHER	4
27	108338	792.64.87	SPECIAL PIN TL-2-207	2
28	108214	BN_924_TAP_D32	POP RIVET TAP/D320	4
29	107912	BN_56_M5x16	HEXAGON HEAD SCREW	3
30	107683	BN_56_M5x20	HEXAGON HEAD SCREW	1
31	107358	BN_721_M6	WASHER	4
32	102332	BN_56_M6x16	HEXAGONAL SCREW	1
33	102289	BN_56_M10x16	HEXAGON HEAD SCREW	2
34	102287	BN_117_M10	HEXAGONAL NUT	4
35	102285	BN_792_M5	SAFETY WASHER	4
36	102271	BN_3_M4x25	ALLEN SCREW	2
37	101670	BN_715_M8	WASHER	4
38	101609	BN_56_M10x35	HEXAGON HEAD SCREW M10x35, DIN 933,	4
39	101600	BN_56_M8x20	HEXAGONAL SCREW	4
40	101590	BN_3_M4x10	ALLEN SCREW	2
41	100615	BN_792_M4	SAFETY WASHER	4
42	100263	BN_161_M8	SAFETY NUT	4
43	107925	BN_56_M6x55	HEXAGON HEAD SCREW	1
44	103768	BN_56_M6x25	HEXAGON HEAD SCREW	2
45	115137		COUNTER NUT M16	1
46	115136		SELF-SEALING GROMMET	1
47	114880		COUNTER NUT M20 PLASTICS	1
48	114814	791.80.52	SCREWED CABLE GLAND M25 PLAST	1
49	114813		SCREWED CABLE GLAND M20 PLAST	2
50	110376	BN_57_M12x45	HEXAGON HEAD BOLT	1
51	115650	665.00.05	STICKER "WARNING CUTTER SHAFT"	1
52	108444	792.64.96	CLAMP	1
53	106665	BN_161_M5	SAFETY NUT	4
54	100595	BN_3_M5x16	HEXAGON SOCKET HEAD CAP SCREW	4
55	702748	655.21.09	CABLE GUIDE	1
56	109462		COUPLING CEE	1
57	114816	791.80.54	BLANK PLUG KS M25	1
58	113920	BN_13292_M12	RIP-LOCK LOCKING WASHER	1
59	707321	668.42.01	STICKER VA-30 SH	1
60	900074		MOLYKOTE BR2 PLUS	0.005
61	900042		LOCTITE 243	0.01
62	900000		CABLE TIE 280X35, NATURAL	5
63	900018		LABEL SWISS DESIGN	1
64	703542		ARROW	1
65	111182		STICKER -CAUTION HIGH VOLTAGE-	2

Material		Dimension	
Drawn By GS	Date 02/08/2019	Approved Date 19/01/2022	Approved By MS
Units : mm		SIZE A2	
		Description VA 30SH ME-MOT.WITHOUT DRUMM	Article Number 707249
		DWG NO 668.21.22f	
Part/Assembly File 6682122.asm		sheet of 1 1	Rev. f

THE INFORMATION CONTAINED IN THIS DRAWING IS THE SOLE PROPERTY OF VON ARX. EOOD. REPRODUCTION IN PART OR WHOLE WITHOUT THE WRITTEN PERMISSION OF VON ARX. EOOD. IS PROHIBITED.