

Operating Manual

Jerneviolen GS-34 7,5kW/GS-43 11kW

Electrical walk behind floor saw

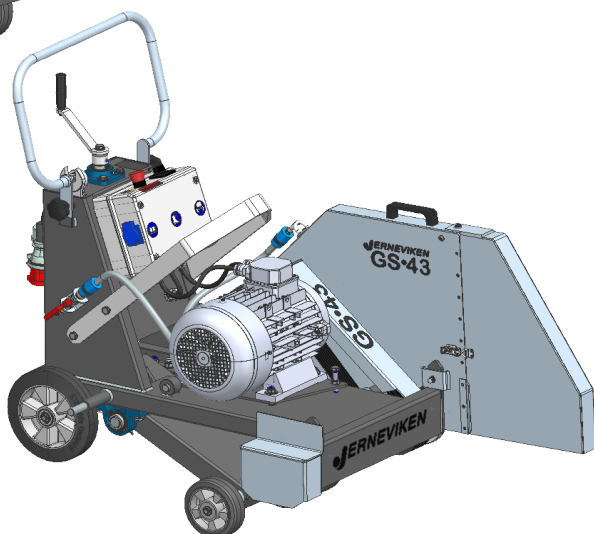
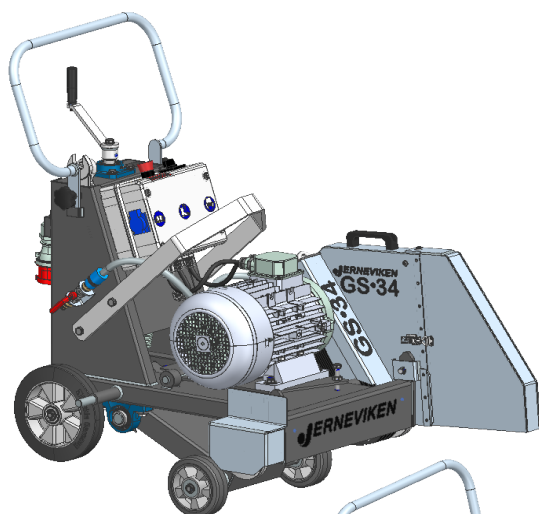

Table of contents

1. General information	4
1.1. Copyright ©	4
1.2. Product description	4
1.3. Intended use	4
1.4. Before using	4
1.5. Reading this Operating Manual	4
1.6. Safekeeping	4
2. Safety instruction and information	5
2.1. Safety definitions	5
2.2. General machine safety warnings	5
2.2.1. Safety signs	5
2.2.2. Work area safety	7
2.2.3. Electrical safety	7
2.2.4. Personal safety	8
2.2.5. Machine use and care	8
2.2.6. Dust warning	9
2.2.7. General safety instructions	9
2.2.8. Safety instructions for operation	10
2.2.9. Grounded product instructions	11
2.2.10. Safety equipments	11
2.2.11. Fire extinguisher	11
3. Device description and operations	12
3.1. Machine part names and numbers	12
3.2. Technical data	15
3.2.1. GS34 7,5kW	15
3.2.2. GS43 11kW	16
3.3. Control panel	16
3.4. Cutting blade install / change	17
3.5. To switch side (form left to right)	20
3.6. To lower the Nr.20 handle	25
3.7. Belt change	25
3.8. Maintenance	29
3.8.1. Maintenance schedule	30
3.9. Work with the electrical walk behind floor saw	31
3.10. Lifting by crane	31

4. Warranty.....	32
5. EC Declaration of Conformity	33
6. Annex: Electric plan.....	34

1. General information

1.1. Copyright ©

The text and illustrations may not be copied or reproduced without the express permission of Jerneviolen.

1.2. Product description

The product is an electrical walk behind floor saw.

1.3. Intended use

This product is used with diamond blades for wet cutting to cut hard floor surface materials such as concrete, asphalt and stone. All other uses are incorrect.

1.4. Before using

It is extremely important that you:

- Make sure that the package is complete and that you check for any possible damage caused during transit/transport.
- Observe the safety instructions.
- Read the Operating Manual.

1.5. Reading this Operating Manual

If there are any questions on your part after reading this Operating Manual please get in touch with the manufacturer or the nearest service center. The manufacturer is not responsible for any damage or breakdown resulting from non-observance of the Operating Manual.

1.6. Safekeeping

Please keep this User Manual in a safe place and available for the users.

2. Safety instruction and information

2.1. Safety definitions

Warnings, cautions and notes are used to point out especially important parts of the manual.



WARNING: Used if there is a risk of injury or death for the operator or bystanders if the instructions in the manual are not obeyed.



CAUTION: Used if there is a risk of damage to the product, other materials or the adjacent area if the instructions in the manual are not obeyed.



NOTE: Used to give more information that is necessary in a given situation.

2.2. General machine safety warnings



WARNING: Read all safety warnings, instructions, illustrations and specifications provided with this machine. Failure to follow all instructions listed below may result in electric shock, fire and/or serious injury.

Save all warnings and instructions for future reference.

2.2.1. Safety signs



Read the operating manual.



Wear hearing protection.



Wear eye protection.



Read the operating manual.





Wear protective gloves.



Wear suitable work clothes and wash dusty clothes



Disconnect before carrying out maintenance or repair



Wear foot protection



Lift point



General warning sign



Electricity hazard



Danger due to ejected parts



Risk of cuts on rotating tool



Wait for all parts to stop moving



Risk of being pulled in by open belt drive



Danger of cuts and amputation through rotary cutting tools



Do not relocate the machine while the tool is rotating



Do not use high-pressure cleaners



No use by unauthorized persons

2.2.2. Work area safety

- Keep the work area clean and well lit. Untidiness in your work area may be a cause for accidents!
- Do not operate machines in explosive atmospheres, such as in the presence of flammable liquids, gasses or dust. Machines create sparks which may ignite the dust or fumes.
- Protect the machine or the tool from moisture, water, extreme heat, extreme cold, chemical solutions and gases.
- Keep other people away!
- Keep other people - especially children - away from the machine or the tool and the power cord.

2.2.3. Electrical safety

- Machine plugs must match the outlet. Never modify the plug!
- Do not use any adapter plugs. Unmodified plugs and matching outlets reduce the risk of electric shock.
- Avoid body contact with earthed or grounded surfaces, such as pipes, radiators, refrigerators and ranges. There is an increased risk of electric shock if your body is earthed or grounded.
- Do not expose machines to rain or wet conditions. Water entering a machine will increase the risk of electric shock.
- Do not abuse the cord. Never use the cord for carrying, pulling or unplugging the machine. Keep cord away from heat, oil, sharp edges or moving parts. Damaged or entangled cords increase the risk of electric shock.
- When operating a machine, use an extension cord suitable for outdoor use. Use of a cord suitable for outdoor use reduces the risk of electric shock.
- When operating a machine, always use a residual current device (RCD) protected supply. Use of an RCD reduces the risk of electric shock.
- Residual Current Device (RCD) must be 30mA at GS-34, GS-43.
- Make sure that the power outlet has the same voltage as shown on the rating plate of the product.
- Check all electrical cables - be sure connections are tight and cable is continuous and in good condition. Be sure cable is correctly rated for both the operating current and voltage of this equipment.



NOTE: In the event of a malfunction or breakdown, grounding provides a path of least resistance for the electric current to dissipate. The motor is equipped with a grounded plug and must be connected to an outlet that is properly installed and properly grounded. DO NOT modify the plug provided on the motor. If the plug does not fit the outlet, have a qualified electrician install the proper receptacle..

- Unplug power cord at the machine when not in use and before servicing.
- Switch motor OFF before disconnecting power.
- Never use frayed, damaged, taped or under rated extension cords. Electrical shock could result in death or serious injury to the operator and damage to the equipment.
- Assure you are using the proper extension cord length.

2.2.4. Personal safety

- Stay alert, watch what you are doing and use common sense when operating a machine. Do not use a machine while you are tired or under the influence of drugs, alcohol or medication. A moment of inattention while operating machines may result in serious personal injury.
- Use personal protective equipment. Always wear eye protection. Protective equipment such as dust masks, non-skid safety shoes, safety helmets or hearing protection used for appropriate conditions will reduce the risk of personal injuries.
- Prevent unintentional starting. Ensure the switch is in the off-position before connecting to the power source, picking up or carrying the tool.
- Remove any adjusting key or wrench before turning the machine on. A wrench or a key left attached to a rotating part of the machine may result in personal injury.
- To store wrenches use the wrench holder.
- Do not overreach. Keep proper footing and balance at all times. This enables better control of the machine in unexpected situations.
- Dress properly. Do not wear loose clothing or jewelry. Keep your hair and clothing away from moving parts. Loose clothes, jewelry or long hair can be caught in moving parts.
- Do not let familiarity gained from frequent use of tools allow you to become complacent and ignore tool safety principles. A careless action can cause severe injury!

2.2.5. Machine use and care

- Never force the machine. Use the correct machine for your application. The correct machine will do the job better and safer at the rate for which it was designed.
- Do not use the machine if the switch does not turn it on and off. Any machine that cannot be controlled with the switch is dangerous and must be repaired.
- Disconnect the plug from the power source and/or remove the battery pack, if detachable, from the machine before making any adjustments, changing accessories, or storing machines. Such preventive safety measures reduce the risk of starting the machine accidentally.
- Store idle machines out of the reach of children and do not allow persons unfamiliar with the machine or their instructions to operate the machine. machines are dangerous in the hands of untrained users.
- Maintain machines and accessories. Check for misalignment or binding of moving parts, breakage of parts and any other condition that may affect the machine's operation. If damaged, have the machine repaired before use. Many accidents are caused by poorly maintained machines.
- Keep cutting tools sharp and clean. Properly maintained cutting tools with sharp cutting edges are less likely to bind and are easier to control.
- Use the machine, accessories and tool bits etc. in accordance with these instructions, taking into account the working conditions and the work to be performed. Use of the machine for operations different from those intended could result in a hazardous situation.

- Keep handles and surfaces dry, clean and free from oil and grease. Slippery handles and surfaces do not allow for safe handling and control of the tool in unexpected situations.

2.2.6. Dust warning

- Some dust created by power sanding, sawing, grinding, drilling, and other construction activities contains chemicals known to cause cancer, birth defects, or other reproductive harm. Materials being removed can be toxic or hazardous. A breathing respirator is required to help protect the operator.
- Some examples of these chemicals are:
 - Crystalline silica from bricks, concrete and other masonry products. Your risk of exposure to these chemicals varies depending on how often you do this type of work. To reduce your risk: work in a well-ventilated area, use a dust control system, such as an industrial-style vacuum, and wear approved personal safety equipment, such as a dust/particle respirator designed to filter out microscopic particles.
 - Lead from lead-based paints.
 - To prevent dust accumulation while cutting, the saw blade must be continuously sprayed with water.
 - Do not eat, drink or smoke in the work area.
 - When working in narrow spaces observe any existing national regulations.

2.2.7. General safety instructions



WARNING: Read the warning instructions that follow before you use the product!

- This product is a dangerous tool if you are not careful or if you use the product incorrectly. This product can cause serious injury or death to the operator or others. Before you use the product, you must read and understand the contents of this operator's manual.
- Save all warnings and instructions.
- Comply with all applicable laws and regulations.
- The operator and the employer of the operator must know and prevent the risks during operation of the product.
- Do not let a person operate the product unless they read and understand the contents of the operator's manual.
- Do not operate the product unless you receive training before use. Make sure that all operators receive training.
- Do not let a child operate the product.
- Only let approved persons operate the product.
- The operator is responsible for accidents that occur to other persons or their property.
- Do not use the product if you are tired, ill, or under the influence of alcohol, drugs or medicine.
- Always be careful and use your common sense.

- This product produces an electromagnetic field during operation. This field can under some circumstances interfere with active or passive medical implants. To decrease the risk of serious injury or death, we recommend persons with medical implants to speak to their physician and the medical implant manufacturer before operating this product.
- Keep the product clean. Make sure that you can clearly read signs and decals.
- Do not use the product if it is defective.
- Do not do modifications to this product.
- Do not operate the product if it is possible that other persons have done modifications to the product.
- Work on the machine's electrical equipment may only be carried out by a qualified electrician or by trained personnel under the management and supervision of a qualified electrician and in compliance with the electronic regulations.
- Before maintenance wires and connectors must be labeled to prevent incorrect reconnection.

2.2.8. Safety instructions for operation



WARNING: Read the warning instructions that follow before you use the product!

- Read the warning instructions that are supplied with the cutting blade by the cutting blade manufacturer.
- Only connect the product to a power supply, which is protected by an applicable fuse or circuit breaker.
- Fuse or circuit breaker must be C16 A at GS-34.
- Fuse or circuit breaker must be C25 A at GS-43.
- Make sure that the product is assembled correctly.
- Do not operate the product without the blade guard and the protective covers correctly installed and attached.
- Do not operate the product with the blade guard front lifted. The blade guard front must be lowered and correctly latched and attached.
- Incorrect operation of the product can cause the cutting blade to break and cause injury or damage.
- Make sure that you know how to stop the motor quickly in an emergency.
- Use personal protective equipment.
- Make sure that only approved persons are in the work area.
- Make sure that electrical cables in the work area are not live.
- Before you operate the product, find out if there are hidden wires, cables and pipes in the work area. If the product hits a hidden object, stop the motor immediately and examine the product and the object. Do not start to operate the product again until you know that it is safe to continue.
- Make sure that you are in a safe and stable position during operation. The product can cause objects to eject at high speed. Make sure that all persons in the work area use approved personal protective equipment.
- Remove loose objects from the work area.
- Before you go away from the product, stop the motor and make sure that there is no risk of accidental start.

- Do not go away from the product without securing it.
- Be very careful during operation on slopes. The product is heavy and can cause serious injury if it falls or moves too quickly.
- Make sure that no material can become loose and cause injury to the operator
- Make sure that clothing, long hair and jewelry do not get caught in moving parts
- Do not operate the product unless you can get aid if an accident occurs

2.2.9. Grounded product instructions



WARNING: Incorrect connection can result in electrical shock. Speak to an approved electrician if you are not sure if your mains outlet is correctly grounded.

- Do not do modifications to the power plug from its factory specification. If the power plug or power cord is damaged or must be replaced, contact your service agent. Obey local regulations and laws.
- If you do not fully understand the instructions about the grounded product, speak to an approved electrician.
- Use only grounded outdoor extension cords with grounding plugs and grounding outlet that accepts the product power plug.
- The grounded extension cord must be max. 25m long and wire cross section must be min. 2.5mm².
- Do not use electrical adapters with the product.
- Maintenance and service work may only be carried out by qualified technical personnel.

2.2.10. Safety equipments



WARNING: Read the warning instructions that follow before you use the product.

- Always use approved personal protective equipment when you operate the product. Personal protective equipment cannot fully prevent injury but it decreases the degree of injury if an accident does occur.
- Regularly do a check of the condition of the personal protective equipment
- Use an approved protective helmet
- Use approved hearing protection
- Use approved respiratory protection
- Use approved eye protection with side protection. There is a high risk of eye injury from thrown objects
- Use protective gloves
- Use boots with steel toe-cap and non-slip sole
- Use approved work clothing or equivalent close fitting clothing that has long sleeves and long legs

2.2.11. Fire extinguisher

- Keep a fire extinguisher near during operation
- Use a powder fire extinguisher or a carbon dioxide fire extinguisher

3. Device description and operations

3.1. Machine part names and numbers

Callout	Number	PD Name	PD Description	Qty
10	5000143	COVER	SAW BLADE	1
20	5000131	HANDLE	GS-34	1
30	5000158	COVER	BLADE AXLE	1
60	5000061	HOLDER	CORD	1
130	5000173	CHASSIS	GS34	1
140	5000122	FASTENER	SAW BLADE INSIDE	2
150	5000121	FASTENER	SAW BLADE OUTSIDE	2
160	5000140	NUT	M24X2 LEFT HAND THREAD	1
170	106508	DIN_934,M24x2,8.8	Hexagon Nut, DIN 934 1987,M24x2,8.8	1
180	104846	DIN_127_B_10,8.8	Spring Lock Washers, Form B DIN_127,10,8.8	2
190	5500040	STAR KNOB	D60 M10X25	2
200	103990	DIN_7091,10,8.8	Plain Washer, DIN 125 (ISO 7091-2000),10,8.8	2
210	5000189	WRENCH	METRIC 32MM	1
220	5000101	WRENCH	METRIC 36 COMBINATION	1
230	5000080	COVER	EXTENSION SAW BLADE	1
240	5000115	STICKER	JERNEVIKEN	1
250	5000193	STICKEKR	GS35	1
260	012480	SCREW	M8X12 HH FT DIN 933 ISO 4017 8.8	2

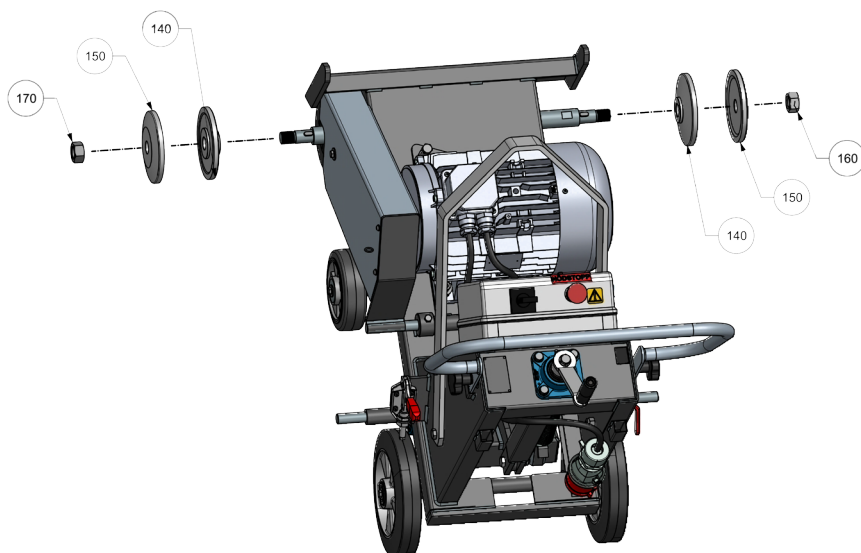
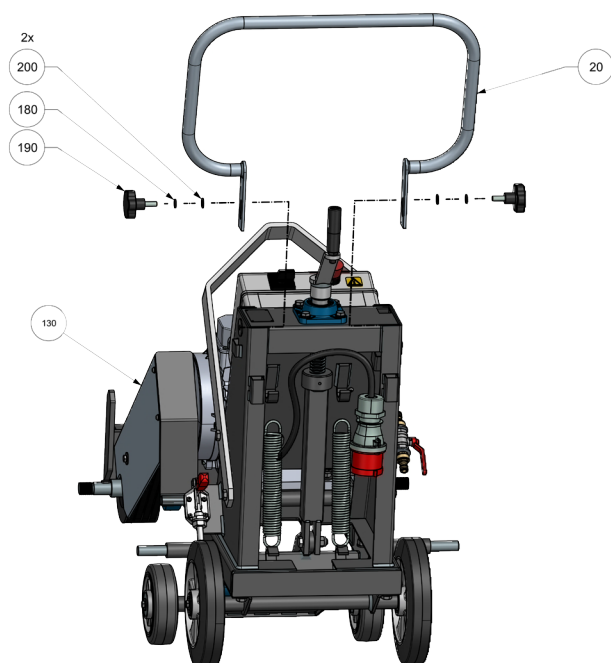

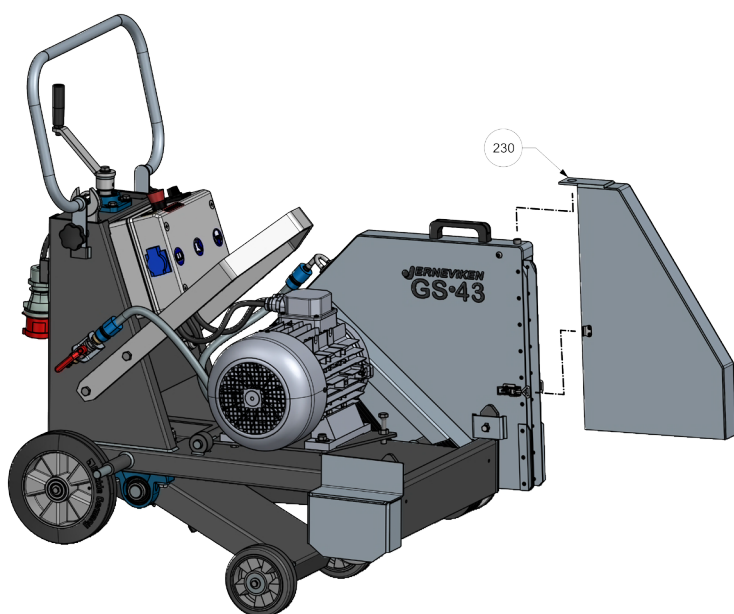
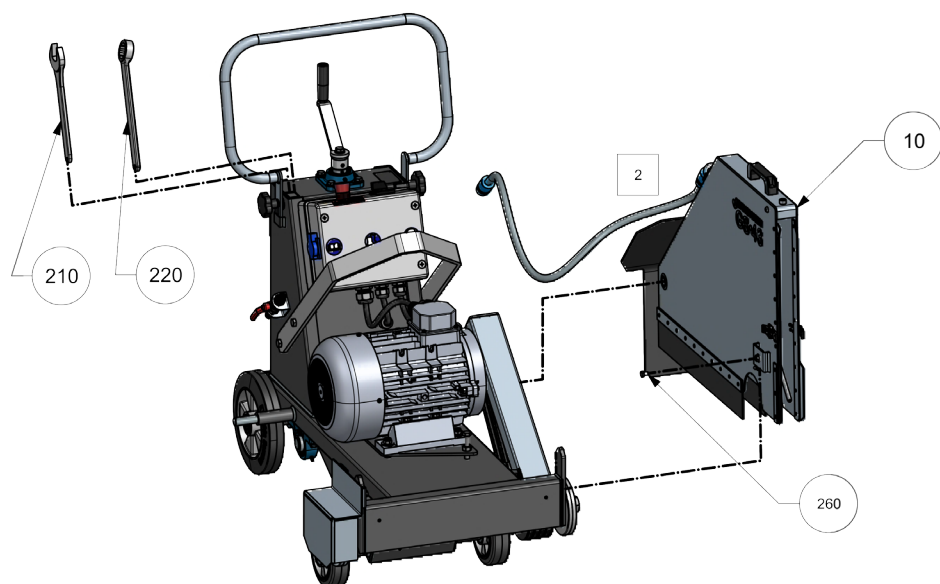

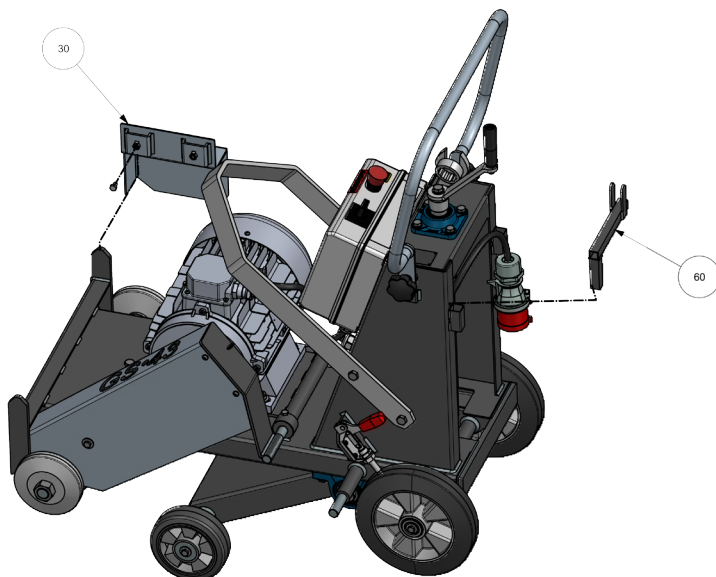

3.2. Technical data

3.2.1. GS34 7,5kW

Max. cutting depth	340mm
Saw blade diameter	800mm
Saw blade arbor (Center hole diameter)	60mm
Saw blade segment width	4,4mm
Saw blade weight	14,7kg
Saw blade rpm (nominal)	1460
Left/right-hand cut	Yes
Power of electric motor	7,5kW
Connector	400V
RCD - Residual Current Device	16A
Weight	172kg
Dimensions without saw blade	H _{max} =1065mm L _{max} =1355mm W _{max} =775mm
The measured sound power level*	L _{WA} =110,76 dB

3.2.2. GS43 11kW

Max. cutting depth	430mm
Saw blade diameter	1000mm
Saw blade arbor (Center hole diameter)	60mm
Saw blade segment width	4,4mm
Saw blade weight	25kg
Saw blade rpm (nominal)	2920
Left/right-hand cut	Yes
Power of electric motor	11kW
Connector	400V
RCD - Residual Current Device	25A
Weight	185kg
Dimensions with saw blade	H _{max} =1065mm L _{max} =1550mm W _{max} =775mm
The measured sound power level*	L _{WA} =109,33 dB

*The emissions sound pressure level was determined in accordance with the EN ISO 3744 and EN 13862 standards and EC Directive 2000/14/EC.

3.3. Control panel

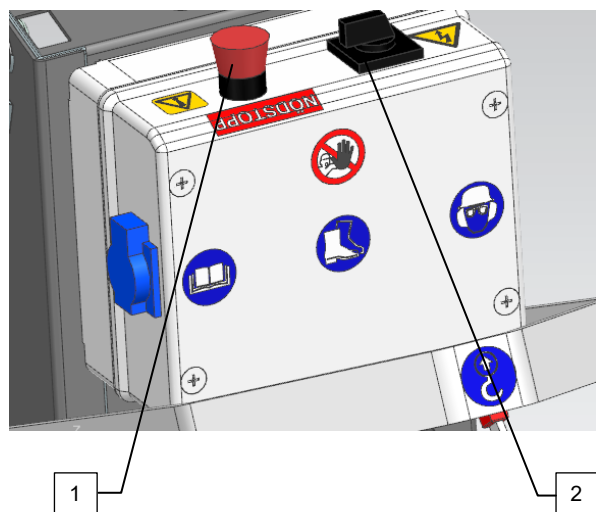

- 1 – Emergency stop button
- 2 – Main switch - start (I) stop (O)
sawblade
- 3 – Safety signs



NOTE: read 2.2.1

3.4. Cutting blade install / change

1. Detach the cover extension of the saw blade.

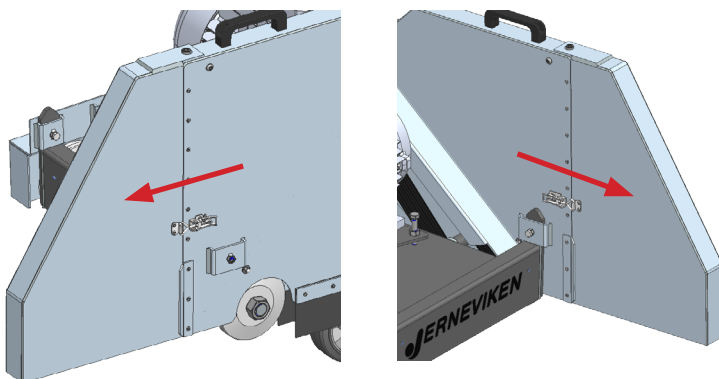

2. Get off the cover extension of the saw blade.

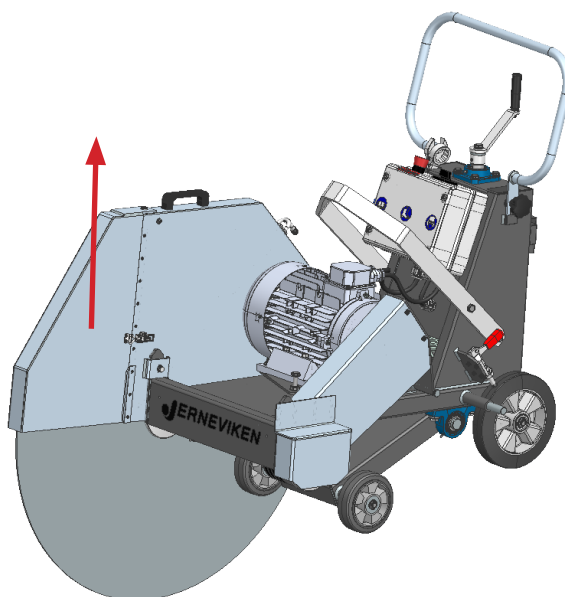

3. Disconnect the quick-connect fitting for cooling water.

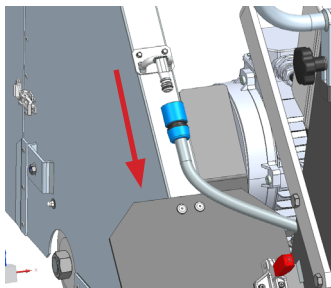

4. Unscrew the Nr.400 blade cover screw.

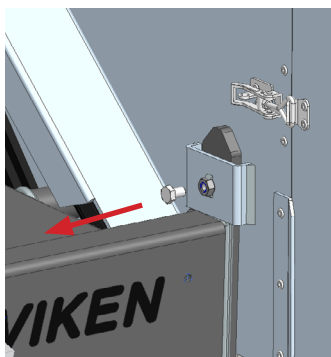

5. Put up the blade cover.

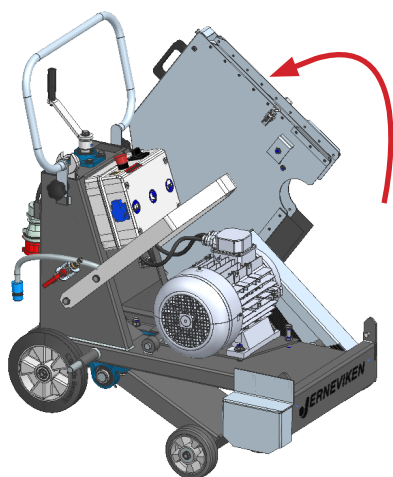

6. Unscrew the nut.

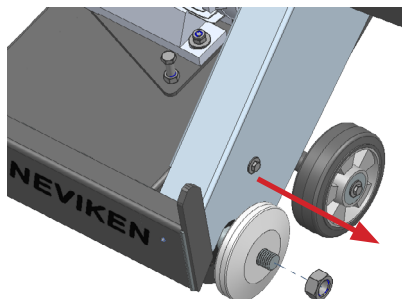

7. Pull off the saw blade fastener

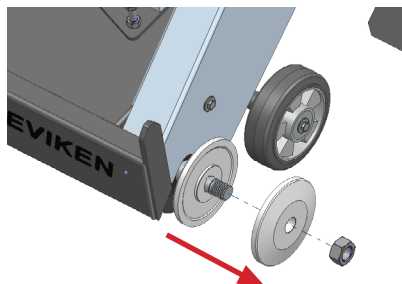

8. Pull off the saw blade

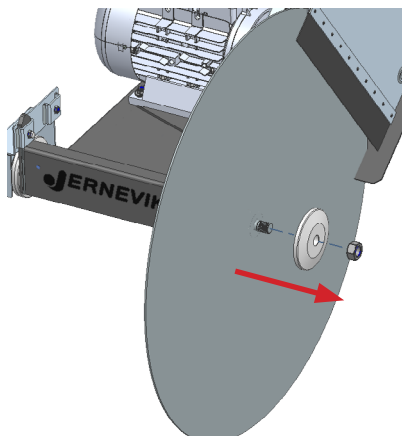

9. Put on the saw blade.
Put on the Nr.150 saw blade fastener.
Fix them with the Nr.170 nut.

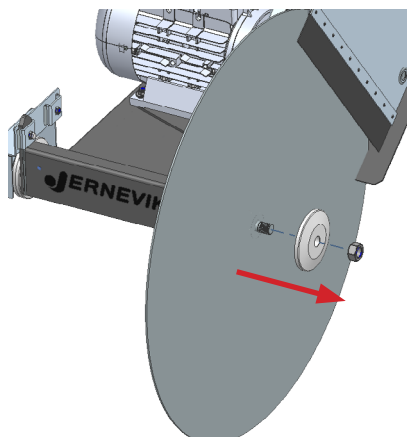

10. Lower the blade cover

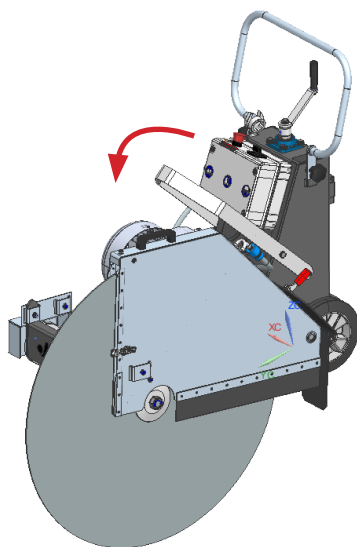

11. Fix the cover with the Nr.260 blade cover screw

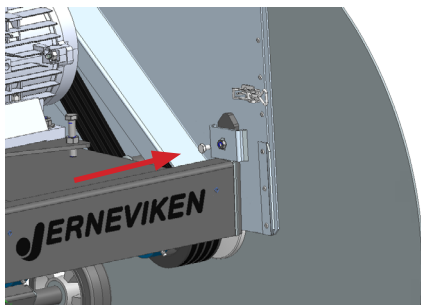

12. Put the blade cover extension back and attach it on both sides

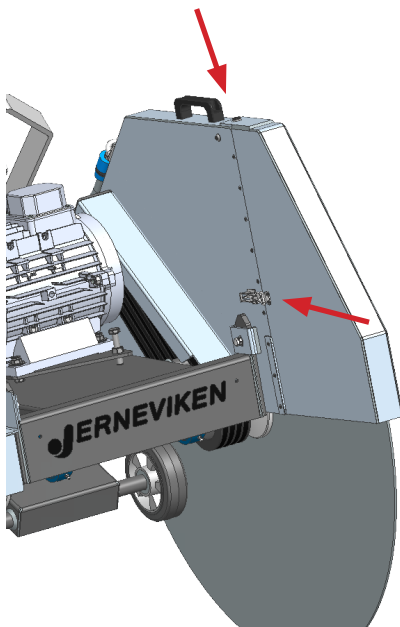

3.5. To switch side (form left to right)

1. Repeat the operations from 1 to 8 in chapter 3.4.
2. Put on the axle the Nr.150 saw blade fastener and fix it with the Nr.170 nut.

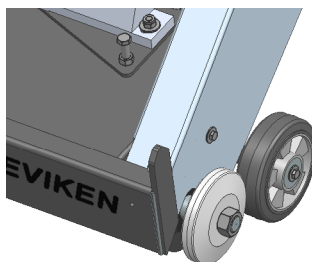
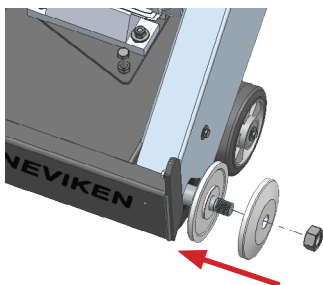

3. Unscrew the Nr.260 screw of the Nr.30 blade axle cover and pull down the Nr.30 axle cover from the plate on the right side

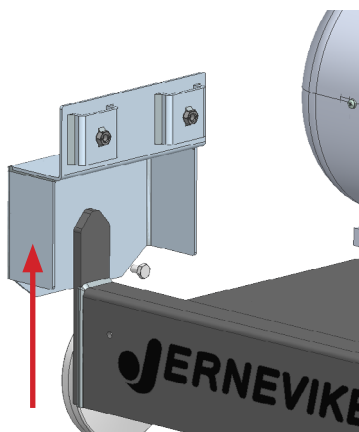
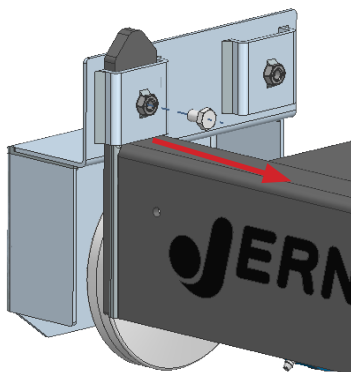

4. Put on the Nr.30 blade axle cover and fix it with the Nr.230 screw on the left side

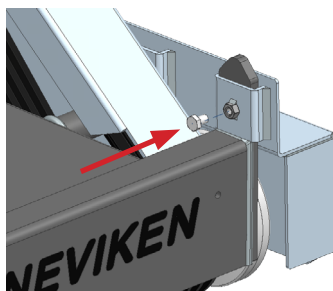
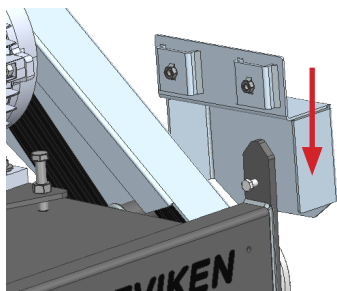

5. Get off the Nr.170 axle nut and pull down the Nr.150 fastener

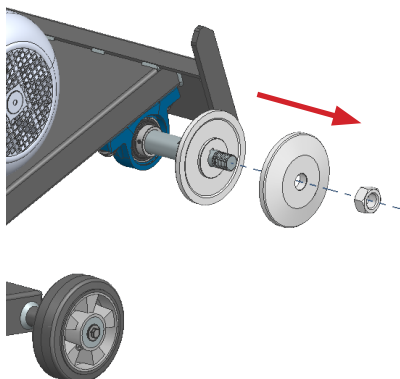
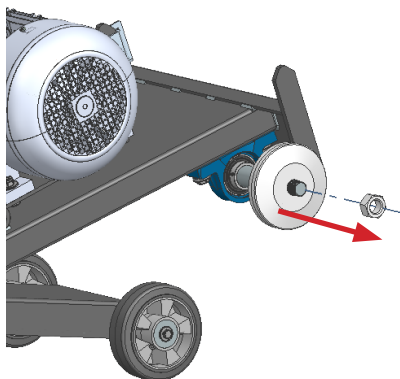

6. Put on the axle the Nr.10 blade cover and after it, put on the saw blade and the Nr. 150 fastener and fix it with the Nr. 170 nut

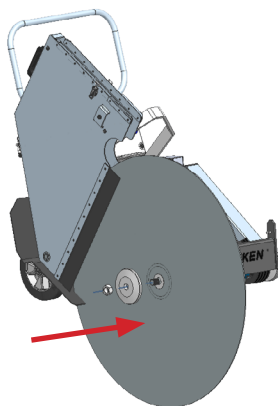
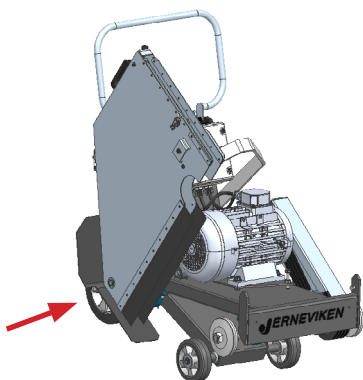

7. Lower the blade cover

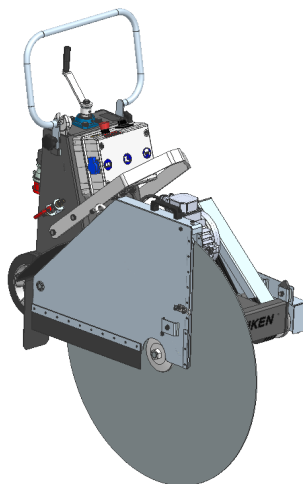
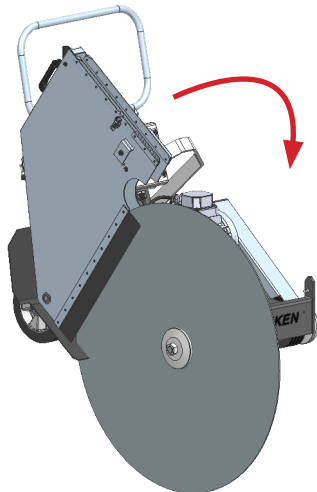

8. Fasten the Nr.10 blade cover with the Nr.260

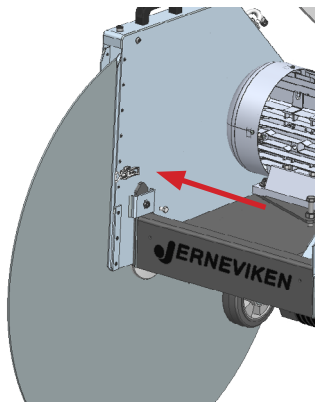

9. Connect the quick-connect fitting for cooling water

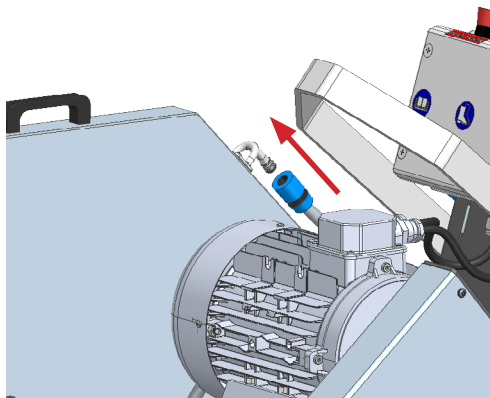

10. Put the blade cover extension on the Nr.10 blade cover and attach it on both sides.

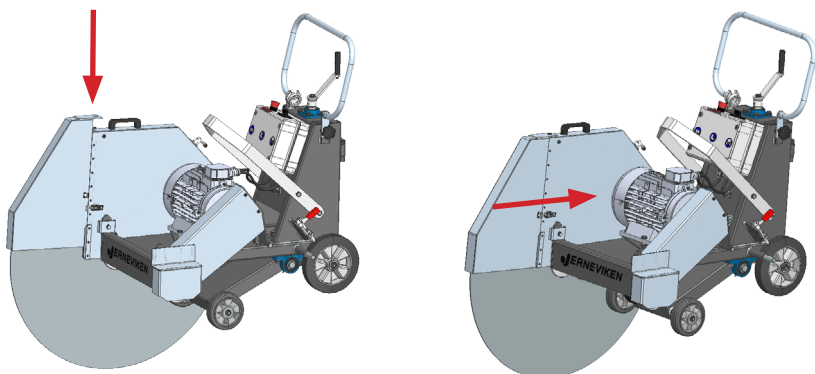

11. Cord holder - side switch

Pull the Nr.60 cord holder from the left socket and put it reverse on the right one

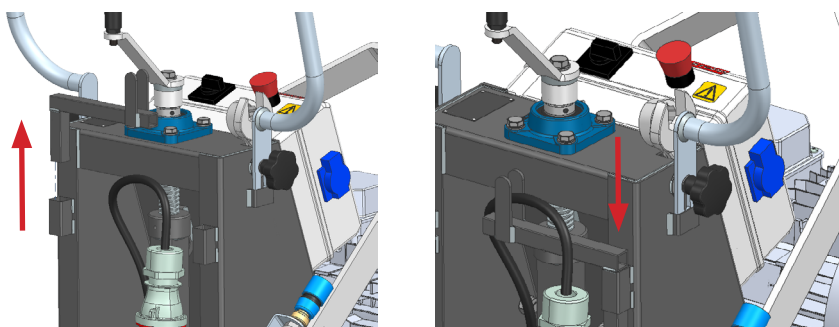

3.6. To lower the Nr.20 handle

1. Loose the two knobs on both sides

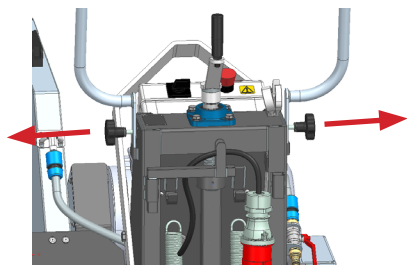

2. Slightly pull up the handle

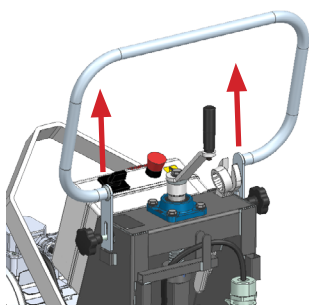

3. Lower the handle forwards and fasten it with the knobs

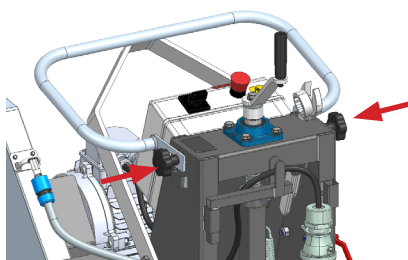
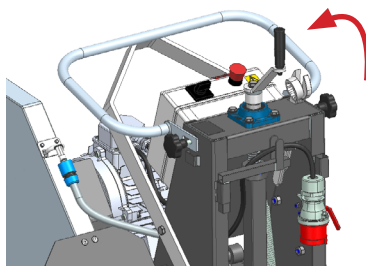

3.7. Belt change

1. Screw down the two screws of the belt cover adapter and loose its fasten bolt

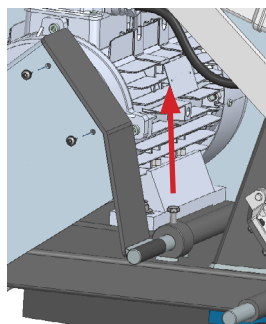
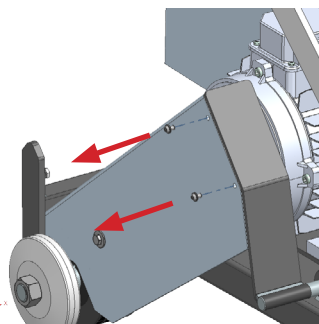

- Put up and pull down the belt cover adapter

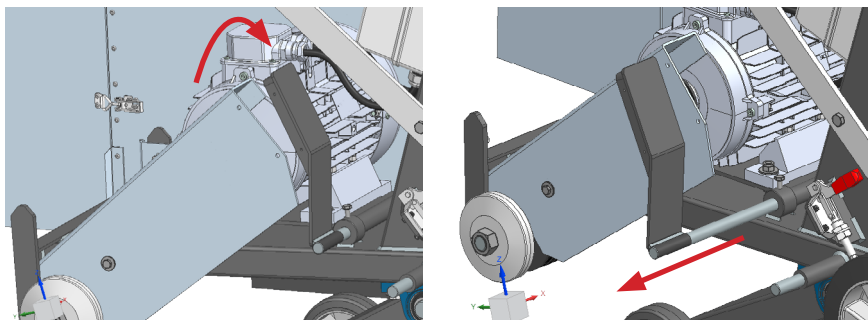

- Screw down the screw of the belt cover and get down the cover

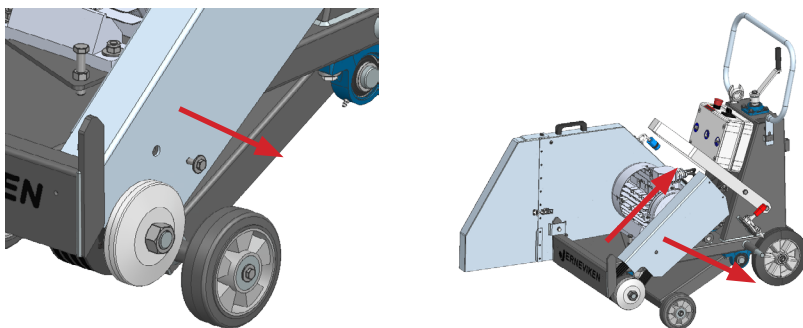

- Loose the fixation of the electric motor (4 joints)

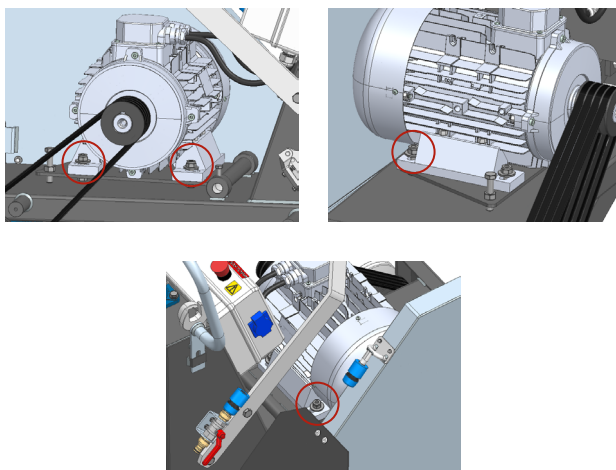

5. Move the electric motor to its end position to ease the belts

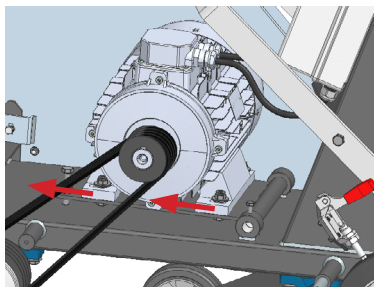

7. Move the electric motor toward its start position until the belts would be tight enough and fix the position of the electric motor

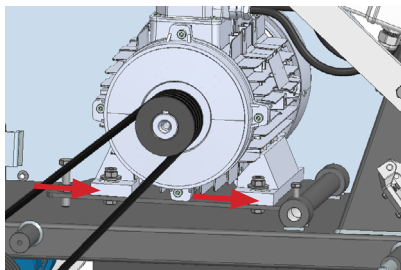

6. Get off the belts and change them

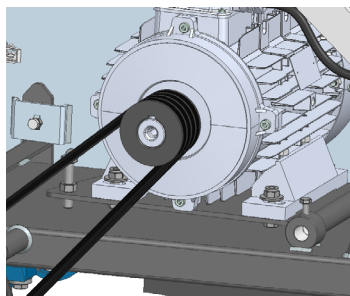
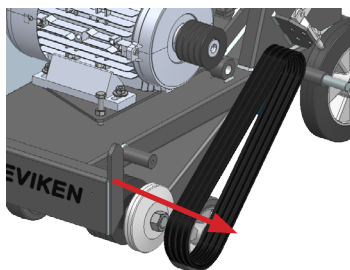

8. Put back the belt cover and fix it with its screw

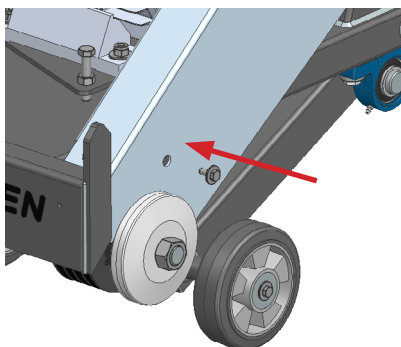
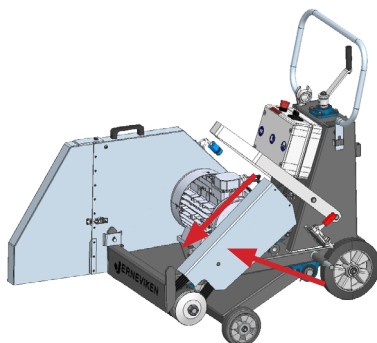

9. Put back the belt cover adapter and fix it with its two screws and the axle fixing bolt

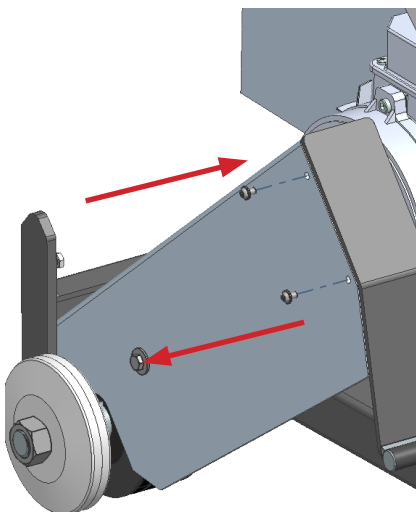
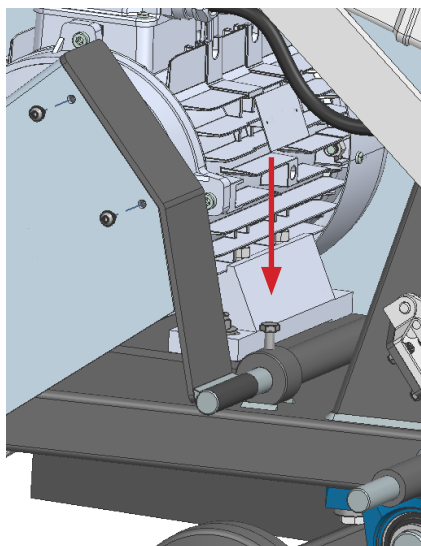
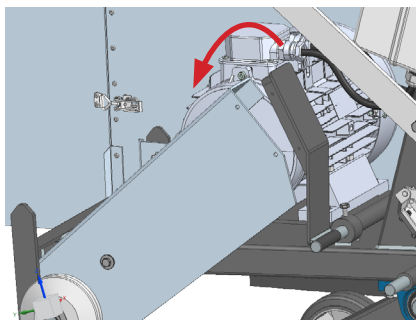
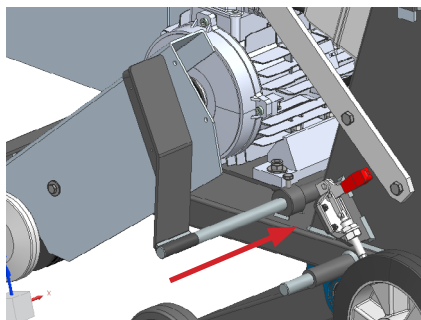

3.8. Maintenance



WARNING: Park the machine on a flat surface and stop the motor. Push the machine stop button on the control panel to prevent accidental start during maintenance.

- Make sure that the machine cannot move during maintenance.
- Engage the parking brake before maintenance.
- Always pull out the plug from the mains outlet before you clean, maintain or assemble the machine.
- Let the machine get cool before maintenance
- Always clean all the equipment at the end of the work day.
- Remove blockage from all air openings.
- Make sure that the nuts and screws on the product are tightened

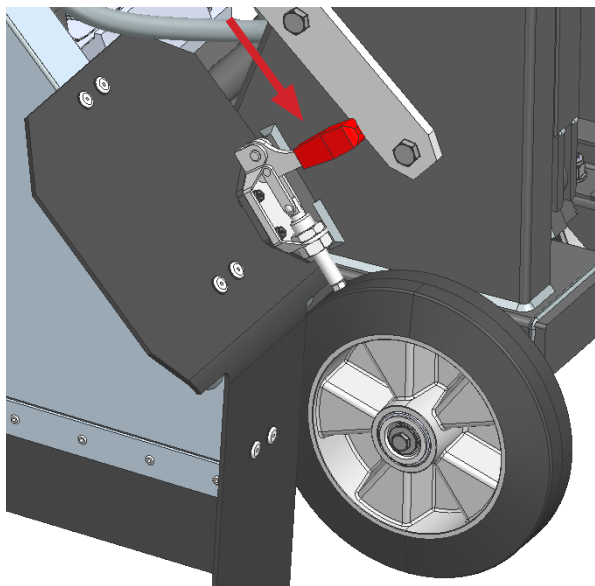

3.8.1. Maintenance schedule

Maintenance	Daily	Weekly	Monthly	Yearly
General inspection	X			
Check the 2 knobs of the handle	X			
Check the drive belts	X			
Check the covers (blade, axle)	X			
Check the cutting blade	X			
Check the ON/OFF buttons	X			
Check the emergency STOP button	X			
Check water connection	X			
After work clean the external surfaces with water	X			
Check the lubrication all of the bearing	X			
Lubricate the bearings, if it is needed*	It depends on usage			
Drive belt change				X
Lubricate the hand wheel nut			X	

*Grease life for insert bearings with VT307 or GFM grease

*Grease life for insert bearings with VT307 or GFM grease

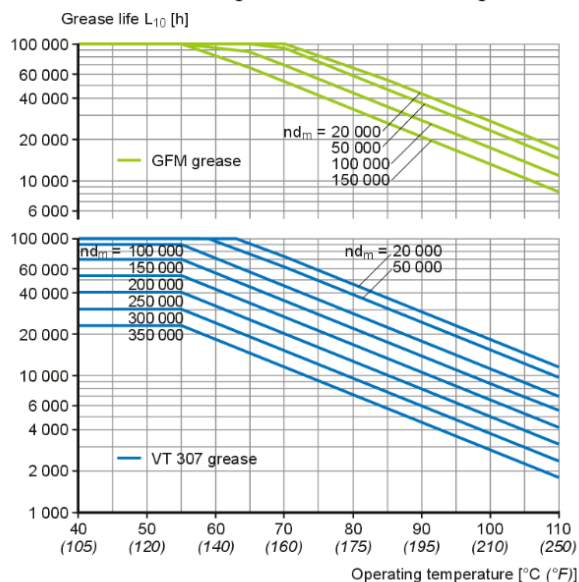

3.9. Work with the electrical walk behind floor saw

1. Make sure that the cutting blade is slightly above the ground.
2. Set main switch I/ON.
3. In less than 5 sec the machine will reach the correct operating speed.
4. Open the valve of the cooling water.
Both side of the cutting blade must have sufficient water supply to cool down the cutting blade.
Adequate water supply also prevents dust formation.
5. Align the cutting blade with the marks on the ground.
6. Slowly turn the cutting depth wheel clockwise to lower the cutting blade.
7. Do cut up to 20mm cutting depth until you reach the necessary depth.
8. Slowly push the product forward and make sure that the cutting blade is aligned with the marks.
9. To switch off:
Lift saw blade fully out of the kerf.
Set main switch 0/OFF.
Stop the motor and wait for all parts to stop moving.
Pull mains plug before leaving the machine or maintain it.

3.10. Lifting by crane



WARNING: Make sure that the lifting equipment has the correct dimension. Make sure that the lifting plate is not damaged. Do not walk or stay below or near a lifted product.

- Use correct lifting equipment to lift the product. Do not lift the product manually.
- Hang the floor saw into the crane lug with a slinging means with sufficient load capacity.
- Use the lifting plate that is attached to the product when you lift it.
- Use boots with steel toe-caps and non-slip soles.
- Use only a suitable transport vehicle with sufficient load capacity.

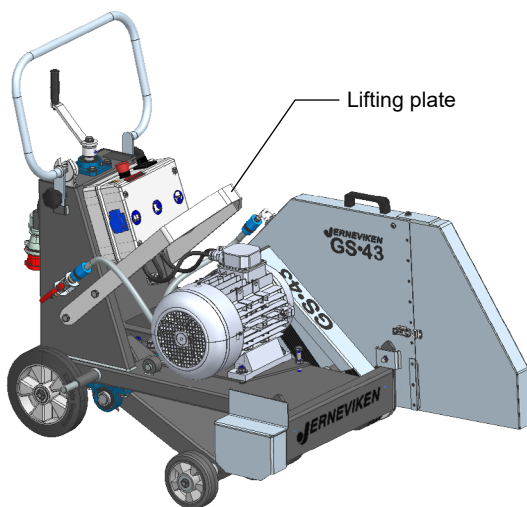

4. Warranty

Jernevik guarantees perfect operation of the unit for a period of 12 months from the date of purchase. If the product is used in shift operation this warranty period is halved.

Jernevik checks all units to ensure they are complete and operating correctly before they leave the works.

The customer must check the machine for any defects or damage in transit immediately on receipt and must inform the sales center and the forwarding agent of any damage or defect without delay.

Jernevik undertakes to correct all faults demonstrably due to defective materials or workmanship within the stated warranty period as quickly as possible or will arrange repair through an official Jernevik Service and sales center.

No liability whatsoever can be accepted for damage due to incorrect handling, disregarding this Operating Manual, overloading, unsuitable use, incorrect maintenance or natural wear and tear. Repairs or modifications made by the purchaser or third parties without our permission in writing are the responsibility of the customer and immediately void our warranty.

In addition, no claim can be considered under the warranty if any parts other than those manufactured or recommended by Jernevik are used.

Blades are parts subject to wear and, owing to this, are not covered by warranty.

Jernevik cannot be held liable for any damage or loss incurred by the purchaser directly or indirectly (consequential loss, loss of profit, extra costs, etc.).

Bought parts such as engines, motors, switches etc. are guaranteed within the warranty determination of the corresponding suppliers.

To prove qualification for a warranty you will need the warranty card and a corresponding commercial invoice of your sales center.

5. EC Declaration of Conformity

In accordance with the EC Machinery Directive 2006/42/EC:

We hereby declare that the equipment described below including its concept, construction and design as marketed by our company complies with the relevant fundamental safety and health requirements of the EC directive. This declaration becomes invalid on any unauthorized modification of the equipment.

Applied Standards	EN ISO 12100:2011 EN 60204-1:2019
Designation of the unit	Electrical walk behind floor saw
Type	Jernevikén GS-34 7,5kW (115V, 230V) Jernevikén GS-43 11kW (115V, 230V)
Country of origin	Bulgaria
Manufacturer	Puvac AB Hägerstensvägen 276 129 38 Hägersten Sweden
Responsible for documentation	Benny Aronsson, MD Puvac EOOD
Place and date	129 38 Hägersten, Sweden 13 January 2023
Name of signatory	Torbjörn Bengtsson
Position of signatory	MBD
Signature	



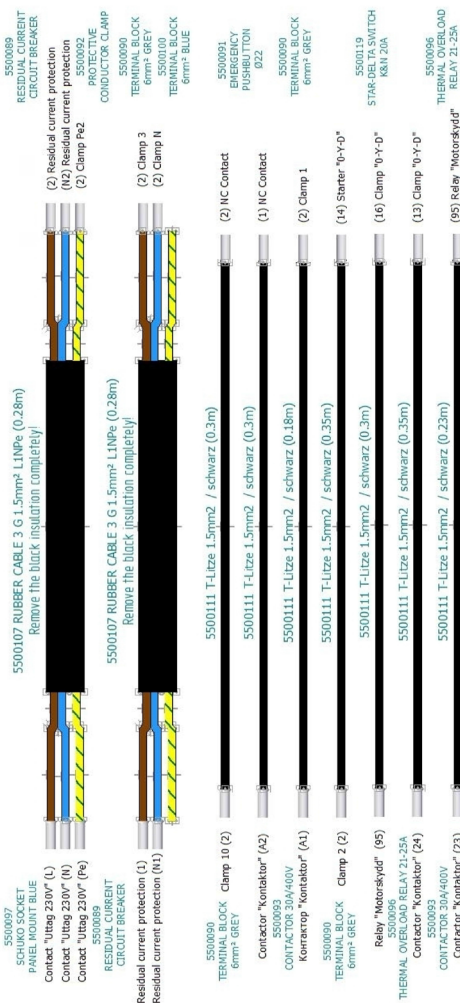

Email: info@puvac.com
www.puvac.com

6. Annex: Electric plan



Cable harnesses
(Strip all cables to 8 mm!)

5500114 UNINSULATED WIRE TERMINAL 1,5mm2 (24 6p.)

LAST ORDER NO.	03	PROJECT NO.	INTERNAL	
5000192	03	5235JR	5235JR	
SET - ELECTRIC COMPONENTS GS-34				PROJECT NO. PR11 - Junction - Fly zone
NOTES	DATE OF ORDER DATE		DATE OF DELIVERY DATE	
	ORDER NO. DATE		ORDER NO. DATE	
NO	CHANGE	DATE	DATE	DATE

THE INFORMATION CONTAINED
IN THIS DRAWING IS THE SOLE
PROPERTY OF JERNEVIKEN MASKIN
REPRODUCTION IN PART OR WHOLE
WITHOUT THE WRITTEN PERMISSION
OF JERNEVIKEN MASKIN AB. PRO

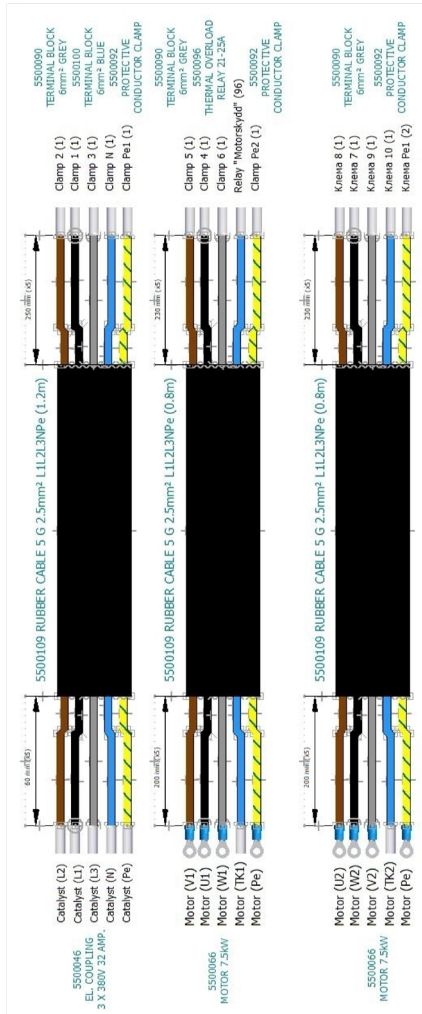

Cable harnesses
(Strip all cables to 8 mm!)

5500115 UNINSULATED WIRE TERMINAL 2,5mm2 (22 6p.)

5500112 CABLE LUG Ø= 4 MM (8 6p.)

[illegible]

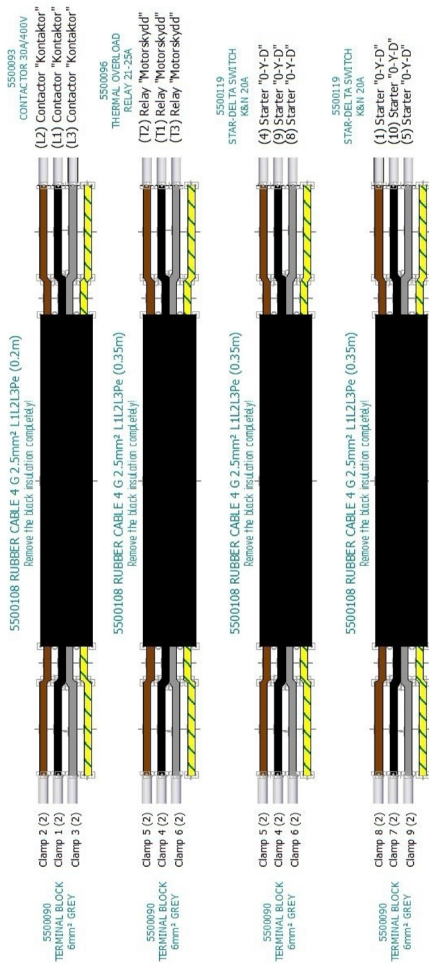

Cable harnesses
(Strip all cables to 8 mm!)

5500115 UNINSULATED WIRE TERMINAL 2.5mm2 (24 6p.)

[illegible]

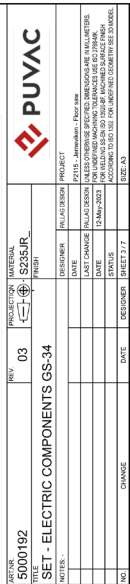

THE INFORMATION CONTAINED
IN THIS DRAWING IS THE SOLE
PROPERTY OF JERNVEIKEN MASKIN AB
REPRODUCTION IN PART OR WHOLE
WITHOUT THE WRITTEN PERMISSION
OF JERNVEIKEN MASKIN AB, PROHIBITED

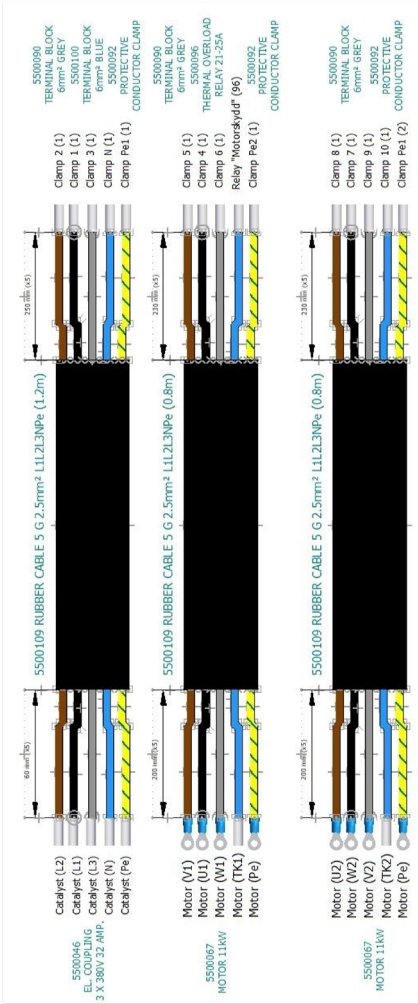

Cable harnesses
15 trip alt cables to 8 mm!

5500115 UNINSULATED WIRE TERMINAL 2.5mm² (22 fcs.)

5500112 CABLE LUG 0~4 MM (8 fcs.)

DRAWING		REV	02	REVISION	5235JR	PROJECT	
5500070		SET - ELECTRIC COMPONENTS GS43		PULADISEN		PULADISEN	
TITLE		PULADISEN		LAST CHANGE		LAST CHANGE	
NOTES		DATE		DATE		DATE	
STATUS		DATE		DATE		DATE	
CHANGE		DATE		DATE		DATE	
NO		DATE		DATE		DATE	
PULADISEN		PULADISEN		PULADISEN		PULADISEN	
PULADISEN		PULADISEN		PULADISEN		PULADISEN	
PULADISEN		PULADISEN		PULADISEN		PULADISEN	
PULADISEN		PULADISEN		PULADISEN		PULADISEN	
PULADISEN		PULADISEN		PULADISEN		PULADISEN	
PULADISEN		PULADISEN		PULADISEN		PULADISEN	
PULADISEN		PULADISEN		PULADISEN		PULADISEN	
PULADISEN		PULADISEN		PULADISEN		PULADISEN	
PULADISEN		PULADISEN		PULADISEN		PULADISEN	
PULADISEN		PULADISEN		PULADISEN		PULADISEN	
PULADISEN		PULADISEN		PULADISEN		PULADISEN	
PULADISEN		PULADISEN		PULADISEN		PULADISEN	
PULADISEN		PULADISEN		PULADISEN		PULADISEN	
PULADISEN		PULADISEN		PULADISEN		PULADISEN	
PULADISEN		PULADISEN		PULADISEN		PULADISEN	
PULADISEN		PULADISEN		PULADISEN		PULADISEN	
PULADISEN		PULADISEN		PULADISEN		PULADISEN	
PULADISEN		PULADISEN		PULADISEN		PULADISEN	
PULADISEN		PULADISEN		PULADISEN		PULADISEN	
PULADISEN		PULADISEN		PULADISEN		PULADISEN	
PULADISEN		PULADISEN		PULADISEN		PULADISEN	
PULADISEN		PULADISEN		PULADISEN		PULADISEN	
PULADISEN		PULADISEN		PULADISEN		PULADISEN	
PULADISEN		PULADISEN		PULADISEN		PULADISEN	
PULADISEN		PULADISEN		PULADISEN		PULADISEN	
PULADISEN		PULADISEN		PULADISEN		PULADISEN	
PULADISEN		PULADISEN		PULADISEN		PULADISEN	
PULADISEN		PULADISEN		PULADISEN		PULADISEN	
PULADISEN		PULADISEN		PULADISEN		PULADISEN	
PULADISEN		PULADISEN		PULADISEN		PULADISEN	
PULADISEN		PULADISEN		PULADISEN		PULADISEN	
PULADISEN		PULADISEN		PULADISEN		PULADISEN	
PULADISEN		PULADISEN		PULADISEN		PULADISEN	
PULADISEN		PULADISEN		PULADISEN		PULADISEN	
PULADISEN		PULADISEN		PULADISEN		PULADISEN	
PULADISEN		PULADISEN		PULADISEN		PULADISEN	
PULADISEN		PULADISEN		PULADISEN		PULADISEN	
PULADISEN		PULADISEN		PULADISEN		PULADISEN	
PULADISEN		PULADISEN		PULADISEN		PULADISEN	
PULADISEN		PULADISEN		PULADISEN		PULADISEN	
PULADISEN		PULADISEN		PULADISEN		PULADISEN	
PULADISEN		PULADISEN		PULADISEN		PULADISEN	
PULADISEN		PULADISEN		PULADISEN		PULADISEN	
PULADISEN		PULADISEN		PULADISEN		PULADISEN	
PULADISEN		PULADISEN		PULADISEN		PULADISEN	
PULADISEN		PULADISEN		PULADISEN		PULADISEN	
PULADISEN		PULADISEN		PULADISEN		PULADISEN	
PULADISEN		PULADISEN		PULADISEN		PULADISEN	
PULADISEN		PULADISEN		PULADISEN		PULADISEN	
PULADISEN		PULADISEN		PULADISEN		PULADISEN	
PULADISEN		PULADISEN		PULADISEN		PULADISEN	
PULADISEN		PULADISEN		PULADISEN		PULADISEN	
PULADISEN		PULADISEN		PULADISEN		PULADISEN	
PULADISEN		PULADISEN		PULADISEN		PULADISEN	
PULADISEN		PULADISEN		PULADISEN		PULADISEN	
PULADISEN		PULADISEN		PULADISEN		PULADISEN	
PULADISEN		PULADISEN		PULADISEN		PULADISEN	
PULADISEN		PULADISEN		PULADISEN		PULADISEN	
PULADISEN		PULADISEN		PULADISEN		PULADISEN	
PULADISEN		PULADISEN		PULADISEN		PULADISEN	
PULADISEN		PULADISEN		PULADISEN		PULADISEN	
PULADISEN		PULADISEN		PULADISEN		PULADISEN	
PULADISEN		PULADISEN		PULADISEN		PULADISEN	
PULADISEN		PULADISEN		PULADISEN		PULADISEN	
PULADISEN		PULADISEN		PULADISEN		PULADISEN	
PULADISEN		PULADISEN		PULADISEN		PULADISEN	
PULADISEN		PULADISEN		PULADISEN		PULADISEN	
PULADISEN		PULADISEN		PULADISEN		PULADISEN	
PULADISEN		PULADISEN		PULADISEN		PULADISEN	
PULADISEN		PULADISEN		PULADISEN		PULADISEN	
PULADISEN		PULADISEN		PULADISEN		PULADISEN	
PULADISEN		PULADISEN		PULADISEN		PULADISEN	
PULADISEN		PULADISEN		PULADISEN		PULADISEN	
PULADISEN		PULADISEN		PULADISEN		PULADISEN	
PULADISEN		PULADISEN		PULADISEN		PULADISEN	
PULADISEN		PULADISEN		PULADISEN		PULADISEN	
PULADISEN		PULADISEN		PULADISEN		PULADISEN	
PULADISEN		PULADISEN		PULADISEN		PULADISEN	
PULADISEN		PULADISEN		PULADISEN		PULADISEN	
PULADISEN		PULADISEN		PULADISEN		PULADISEN	
PULADISEN		PULADISEN		PULADISEN		PULADISEN	
PULADISEN		PULADISEN		PULADISEN		PULADISEN	
PULADISEN		PULADISEN		PULADISEN		PULADISEN	
PULADISEN		PULADISEN		PULADISEN		PULADISEN	
PULADISEN		PULADISEN		PULADISEN		PULADISEN	
PULADISEN		PULADISEN		PULADISEN		PULADISEN	
PULADISEN		PULADISEN		PULADISEN		PULADISEN	
PULADISEN		PULADISEN		PULADISEN		PULADISEN	
PULADISEN		PULADISEN		PULADISEN			

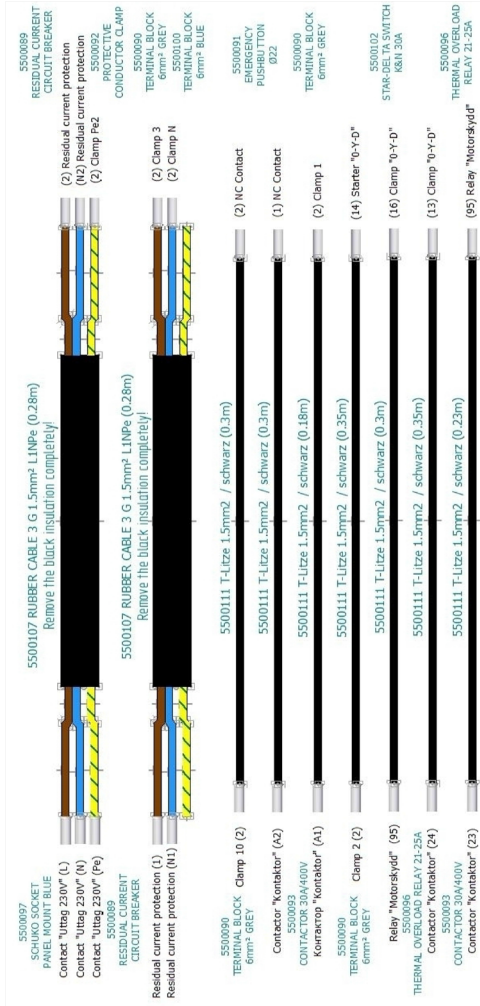

Cable harnesses

(Strip all cables to 8 mm!)

5500114 UNINSULATED WIRE TERMINAL 1,5mm2 (24 6p.)

[illegible]

THE INFORMATION CONTAINED
IN THIS DRAWING IS THE SOLE
PROPERTY OF JERNVEIKEN MASKIN AB.
REPRODUCTION IN PART OR WHOLE
WITHOUT THE WRITTEN PERMISSION
OF JERNVEIKEN MASKIN AB PROHIBITED.

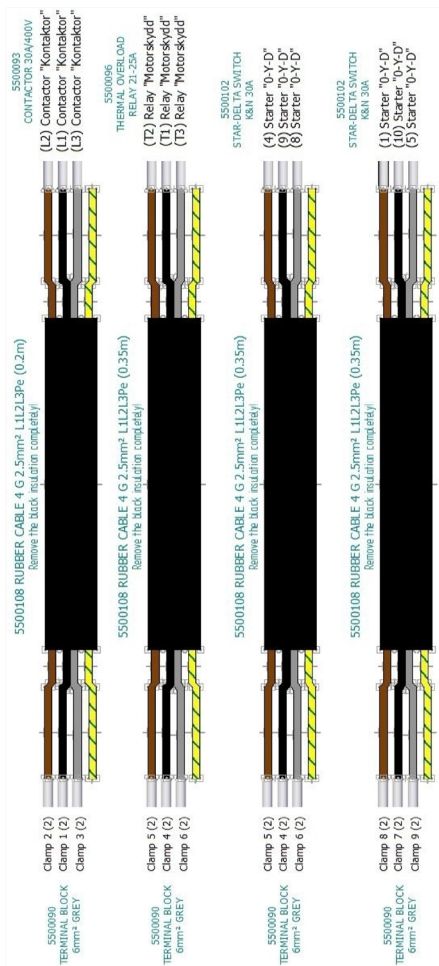

Cable harnesses
(Strip all cables to 8 mm!)

5500115 UNINSULATED WIRE TERMINAL 2,5mm2 (24 6p.)

[illegible]

THE INFORMATION CONTAINED
IN THIS DRAWING IS THE SOLE
PROPERTY OF JERNVIKEN MASKIN AB
REPRODUCTION IN PART OR WHOLE
WITHOUT THE WRITTEN PERMISSION
OF JERNVIKEN MASKIN AB PROHIBITED

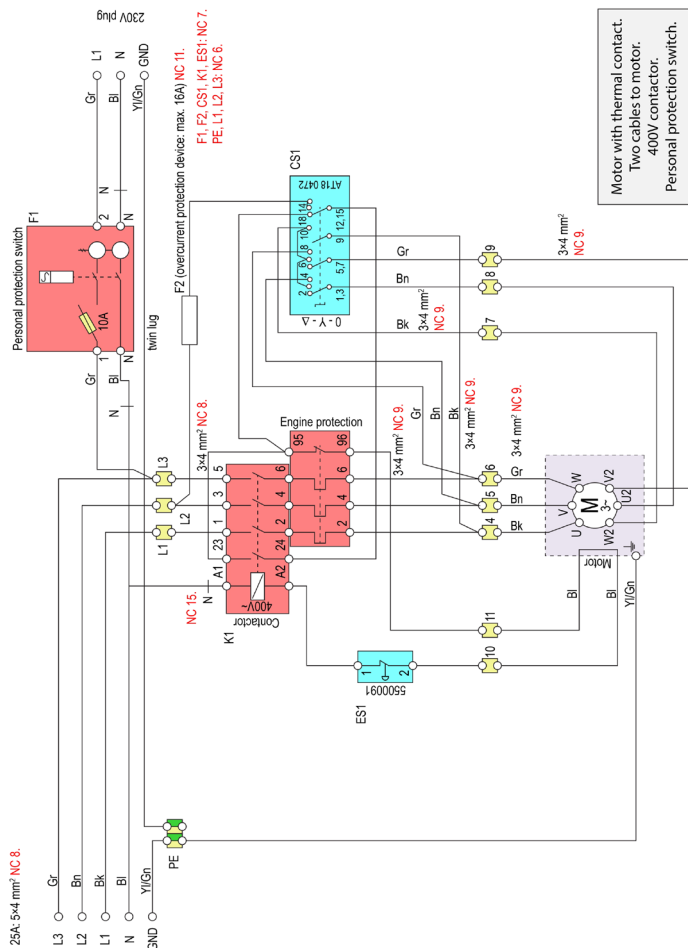

Motor with thermal contact.
Two cables to motor.
400V contactor.
Personal protection switch.

THE INFORMATION CONTAINED
IN THIS DRAWING IS THE SOLE
PROPERTY OF PUVAC HUNGARY KFT.
REPRODUCTION IN PART OR WHOLE
WITHOUT THE WRITTEN PERMISSION
OF PUVAC HUNGARY KFT. PROHIBITED.

DATE REC'D	02	REV	02	DATE SHIP	02/25/2017	DATE ORDER	02/25/2017	DATE SHIP	02/25/2017	DATE ORDER	02/25/2017
QUANTITY	5253JR	QUANTITY	5253JR	QUANTITY	5253JR	QUANTITY	5253JR	QUANTITY	5253JR	QUANTITY	5253JR
PRICE		PRICE		PRICE		PRICE		PRICE		PRICE	
											
SET - ELECTRIC COMPONENTS GS43											
DATE REC'D	02	REV	02	DATE SHIP	02/25/2017	DATE ORDER	02/25/2017	DATE SHIP	02/25/2017	DATE ORDER	02/25/2017
QUANTITY	5253JR	QUANTITY	5253JR	QUANTITY	5253JR	QUANTITY	5253JR	QUANTITY	5253JR	QUANTITY	5253JR
PRICE		PRICE		PRICE		PRICE		PRICE		PRICE	
											
SET - ELECTRIC COMPONENTS GS43											
DATE REC'D	02	REV	02	DATE SHIP	02/25/2017	DATE ORDER	02/25/2017	DATE SHIP	02/25/2017	DATE ORDER	02/25/2017
QUANTITY	5253JR	QUANTITY	5253JR	QUANTITY	5253JR	QUANTITY	5253JR	QUANTITY	5253JR	QUANTITY	5253JR
PRICE		PRICE		PRICE		PRICE		PRICE		PRICE	
											
SET - ELECTRIC COMPONENTS GS43											

